

8:46 am EST

6:00 am EST

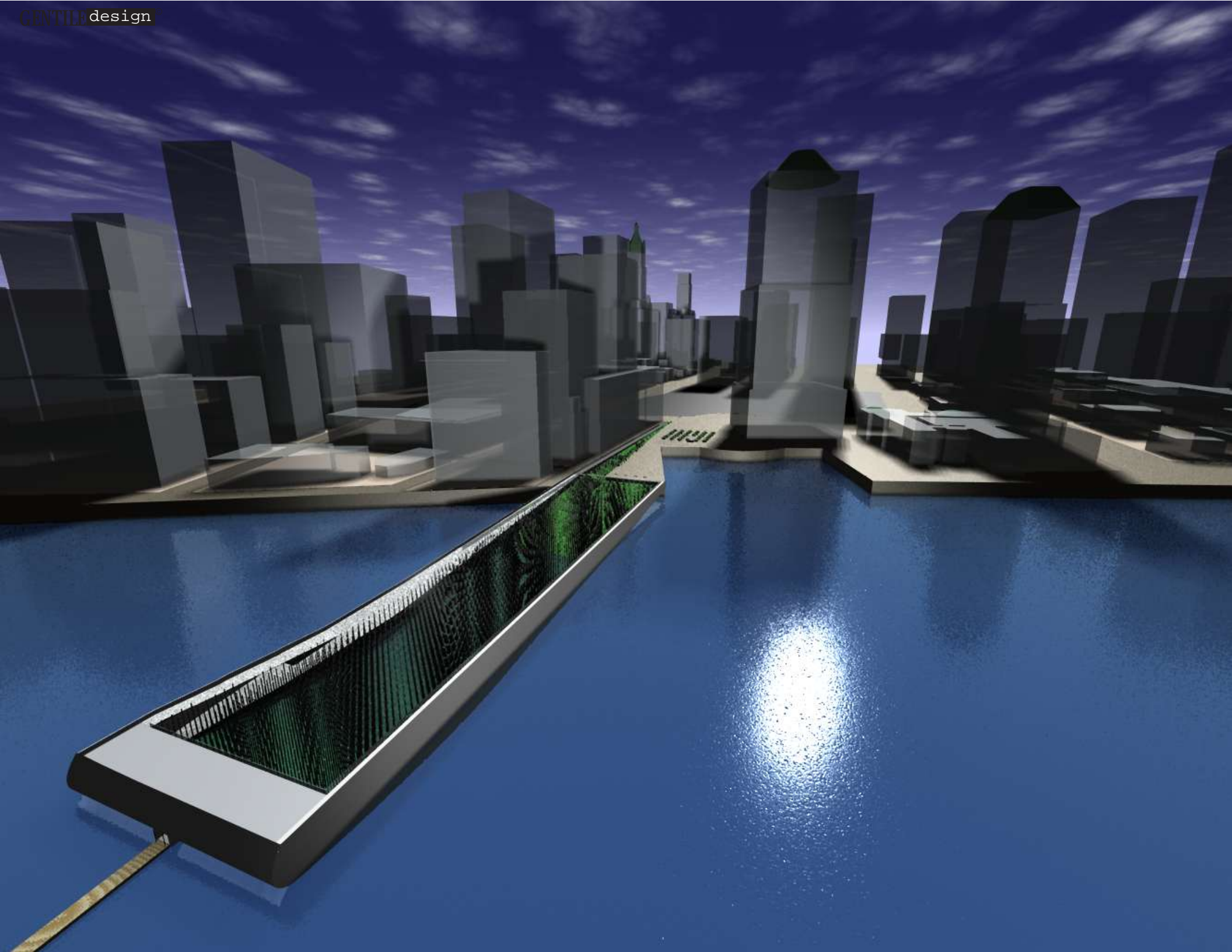

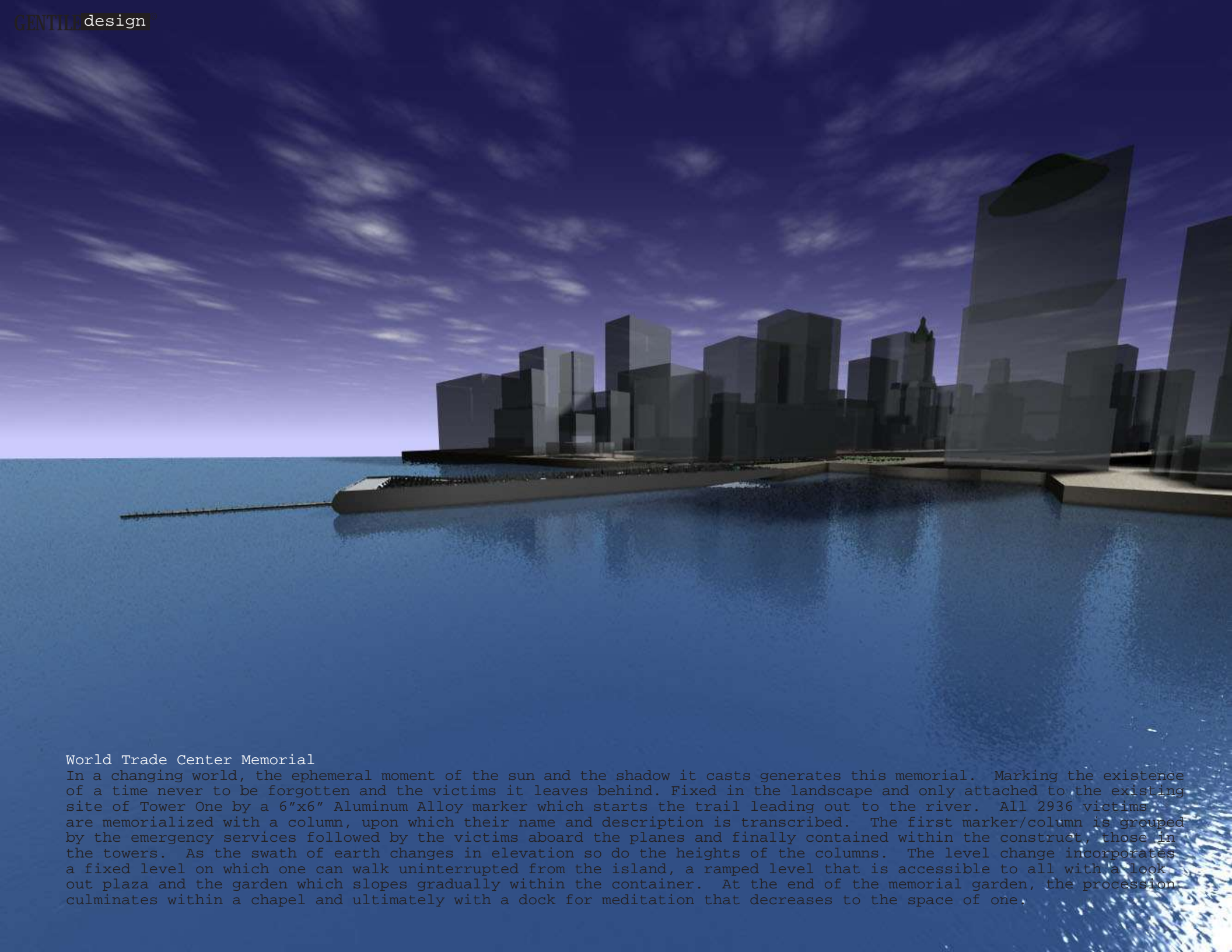

### World Trade Center Memorial

In a changing world, the ephemeral moment of the sun and the shadow it casts generates this memorial. Marking the existence of a time never to be forgotten and the victims it leaves behind. Fixed in the landscape and only attached to the existing site of Tower One by a 6"x6" Aluminum Alloy marker which starts the trail leading out to the river. All 2936 victims are memorialized with a column, upon which their name and description is transcribed. The first marker/column is grouped by the emergency services followed by the victims aboard the planes and finally contained within the construct, those in the towers. As the swath of earth changes in elevation so do the heights of the columns. The level change incorporates a fixed level on which one can walk uninterrupted from the island, a ramped level that is accessible to all with a look out plaza and the garden which slopes gradually within the container. At the end of the memorial garden, the procession culminates within a chapel and ultimately with a dock for meditation that decreases to the space of one.

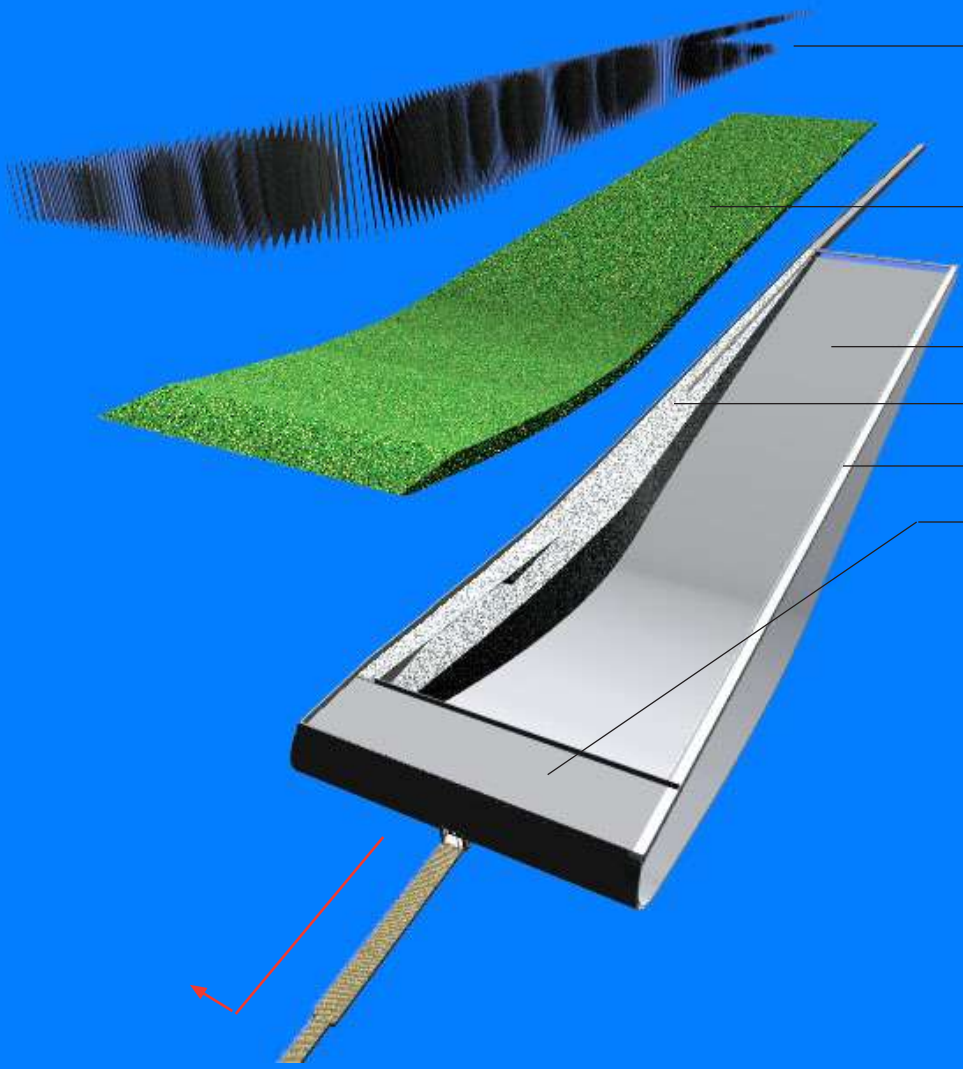

Aluminum Alloy Columns

Size: 6"x6"xVaries  
Qty: 2936 (01.03.02)

Grass w/ Lattice Pavers

Soil (Exhumed from Fresh Kills Landfill)

Concrete Container

Ramp & Viewing Plaza

Upper Walkway

Memorial Chapel

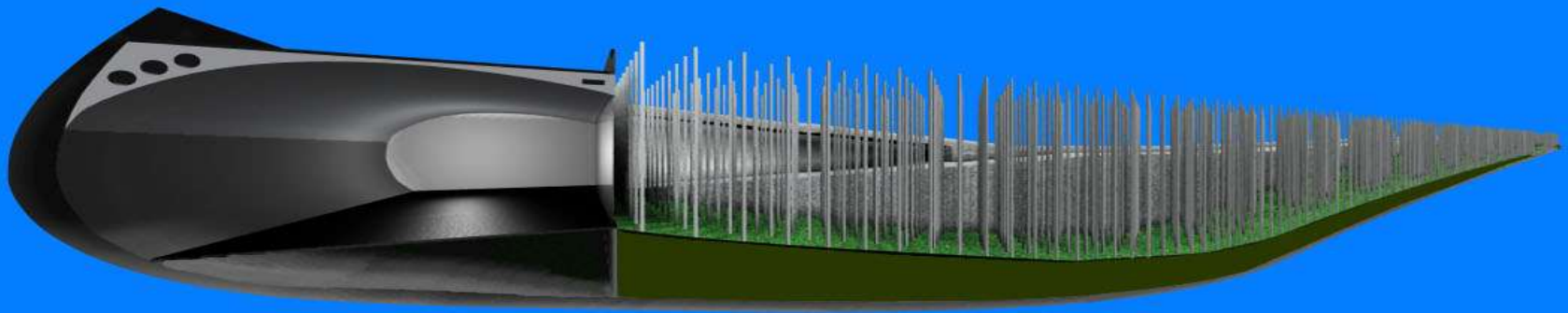
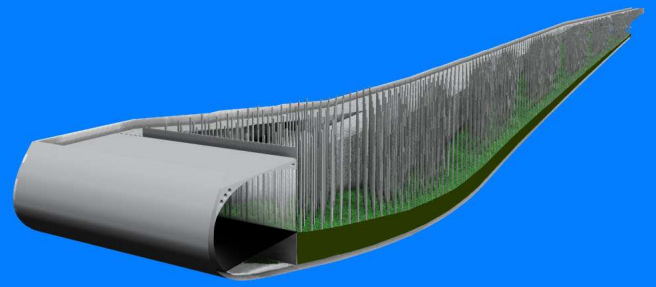

Longitudinal Section

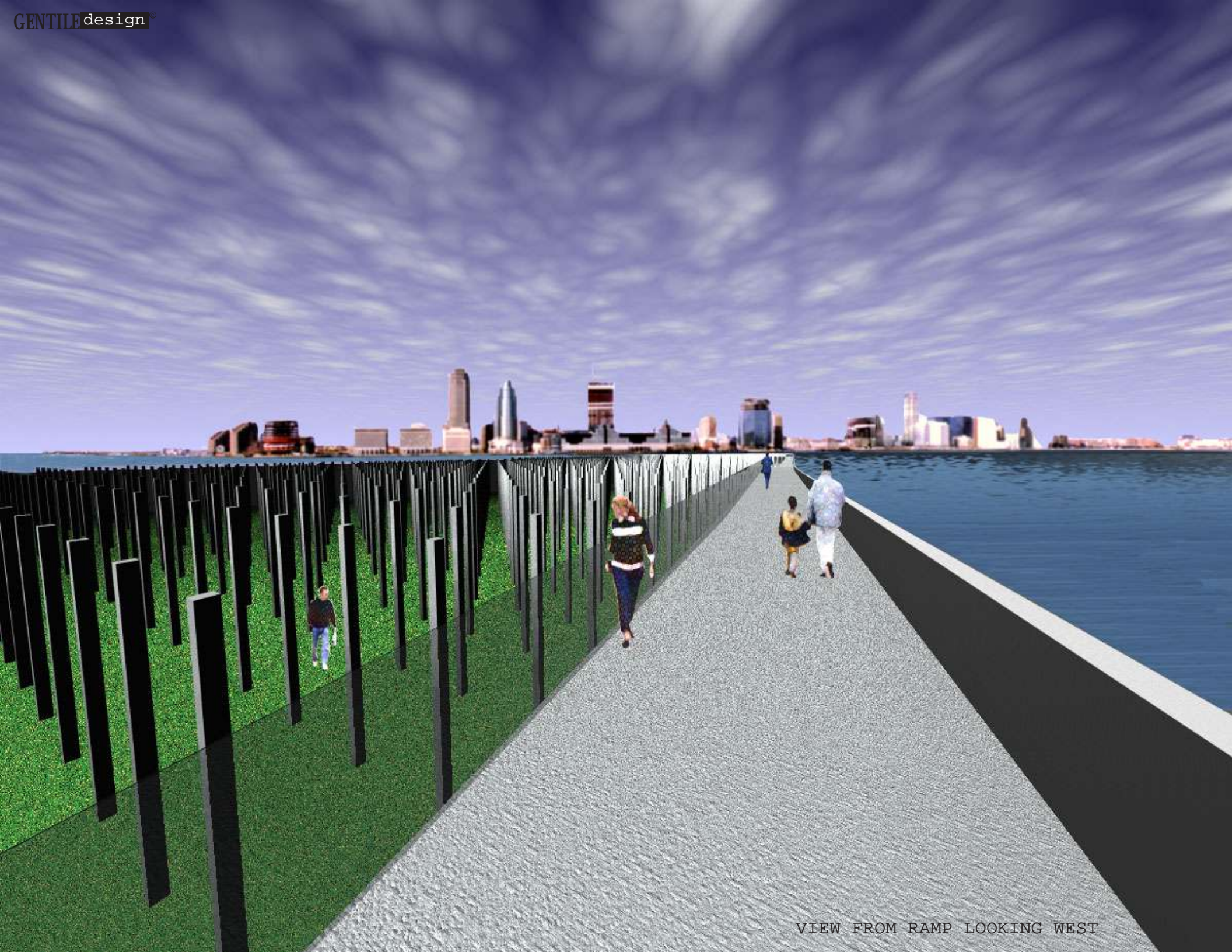

VIEW FROM RAMP LOOKING WEST

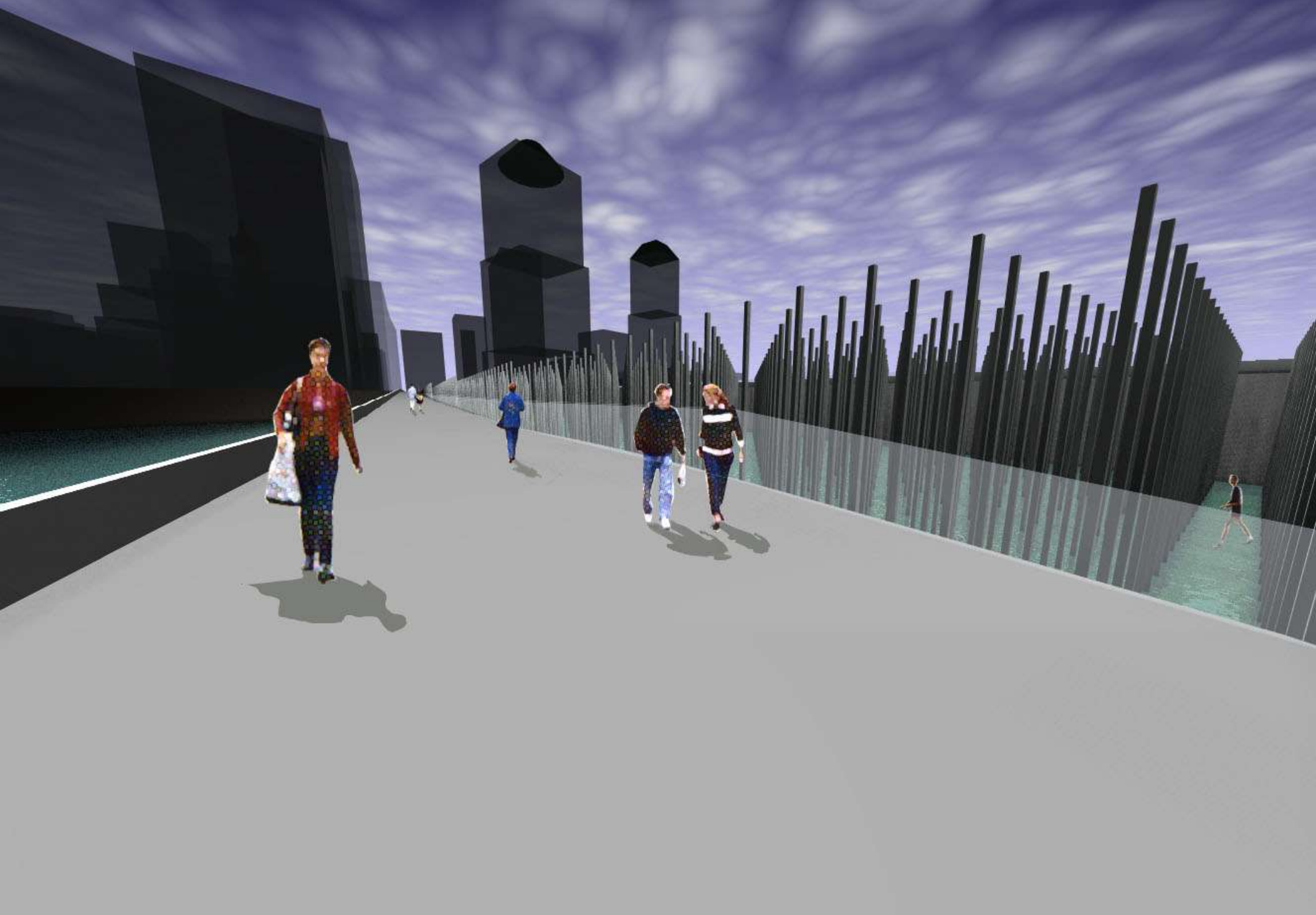

VIEW FROM RAMP LOOKING EAST

